

LASER®

Part No. 4748

Suspension Bush Remover | Installer Volkswagen Audi Group



TOOL CONNECTION
The Complete Connection

Distributed by The Tool Connection Ltd

Kington Road, Southam, Warwickshire CV47 0DR
T +44 (0) 1926 815000 F +44 (0) 1926 815888

Guarantee

If this product fails through faulty materials or workmanship, contact our service department direct on: **+44 (0) 1926 818186**. Normal wear and tear are excluded as are consumable items and abuse.

www.lasertools.co.uk

www.lasertools.co.uk

Content

This bush removal tool is designed for the rear bush on the front wishbone (Console bush) found on Volkswagen Polo (02-07), Volkswagen Fox (02-07) Skoda Fabia (02-07), and Seat Ibiza 02 onwards after Chassis 6K-2-000 001) and Seat Cordoba (02-07), Seat Cordoba, Seat Ibiza, Skoda Fabia, Volkswagen Polo, Volkswagen Fox. All 02-07

OEM T10030, 3301, 473, T30035

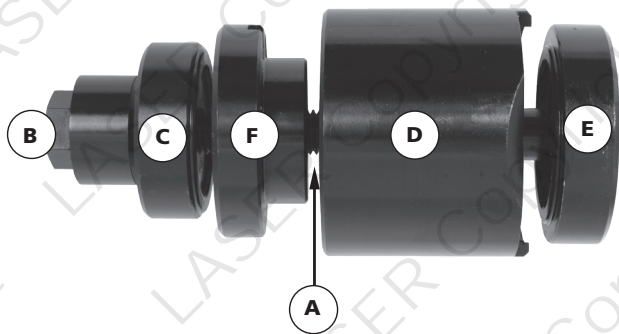

Ref	Spare Part No	Description
A	0775	Threaded centre bar
B	0776	Thrust Nut
C		Extractor adaptor (small)
D		Extractor cup
E		Installer adaptor (rear)
F		Installer adaptor (front)

Instruction

INSTRUCTIONS GUIDE - BUSH REMOVAL

The Bar (A) and Thrust Nut (B), should be lubricated before and after each use.

- Support vehicle on axle stands paying particular attention to all safety precautions.
- In order to remove the bush with the arm and carrier in situ it will be necessary to use a 24mm spanner, to speed up the operation we recommend the use of a 24mm ratchet ring spanner. If the carrier is removed from the vehicle a 24mm socket and ratchet can be used.
- Hold the Small extractor adaptor (C) against the back of the bush (shaped face of adaptor to bush)
- Push Bar (A) through the bush, and thread into adaptor (C)
- Fit Extractor cup (D) over the Bar so that the angled section fits with the angled part of the carrier. The face of the cup has a small 'c' shaped cut out that will align with a mark on the carrier and a moulded 'pip' on the face of the bush.
- Thread the Nut (A) onto the Bar enough to hold the tool in place. Tighten the Nut slowly to draw the bush through the carrier.

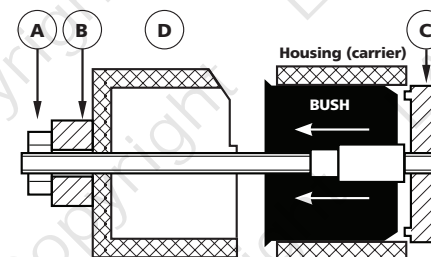

INSTRUCTIONS GUIDE - BUSH INSTALLATION

- Adaptor (E) locates on the back face of the carrier. Thread Bar (A) into the Adaptor. Slide the new bush over the Bar.
- Lubricating the outside of the bush with liquid soap, will help installation
- Fit Adaptor (F), ensuring that its cut out and the bushes moulded 'pip' both align with the mark on the carrier.
- Thread the Nut (A) onto the Bar enough to holds the tool in place. Tighten the nut slowly to press the bush into the carrier.
- Refit the carrier to the vehicle.
- Refit the wishbone.

Due to the nature of this application the Threaded Bar and Nut are considered consumable and therefore are not covered by our guarantee. Replacement parts are available from The Tool Connection or your local Motor Factor.

